

Eastern Area Planning Committee

3rd December 2020

7) 19/10845/FUL Manor Farm, The Street, All Cannings, SN10 3PF
Retention of access track in its current form
Recommendation: Approve with Conditions



Site Location Plan



Aerial Photography



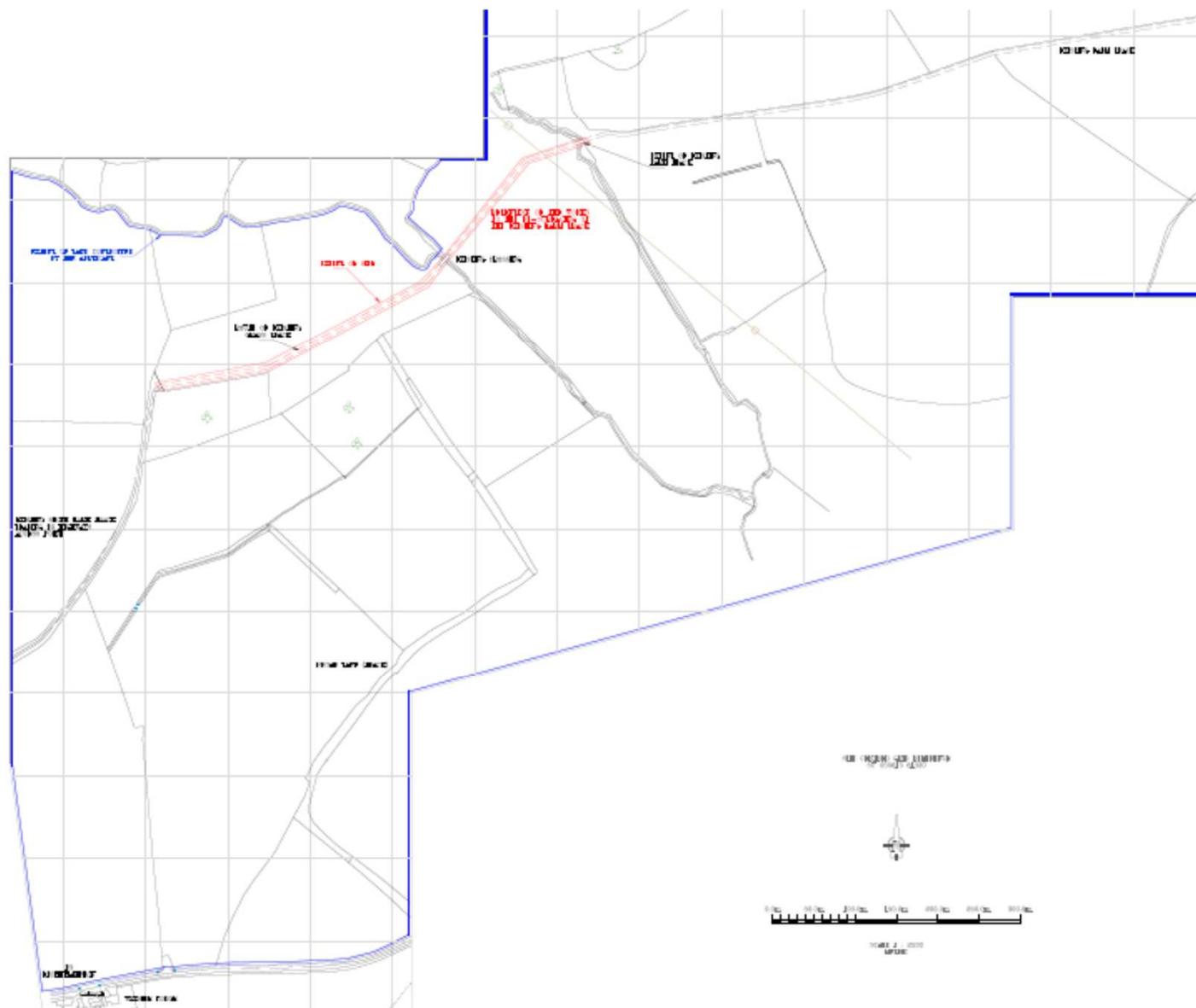

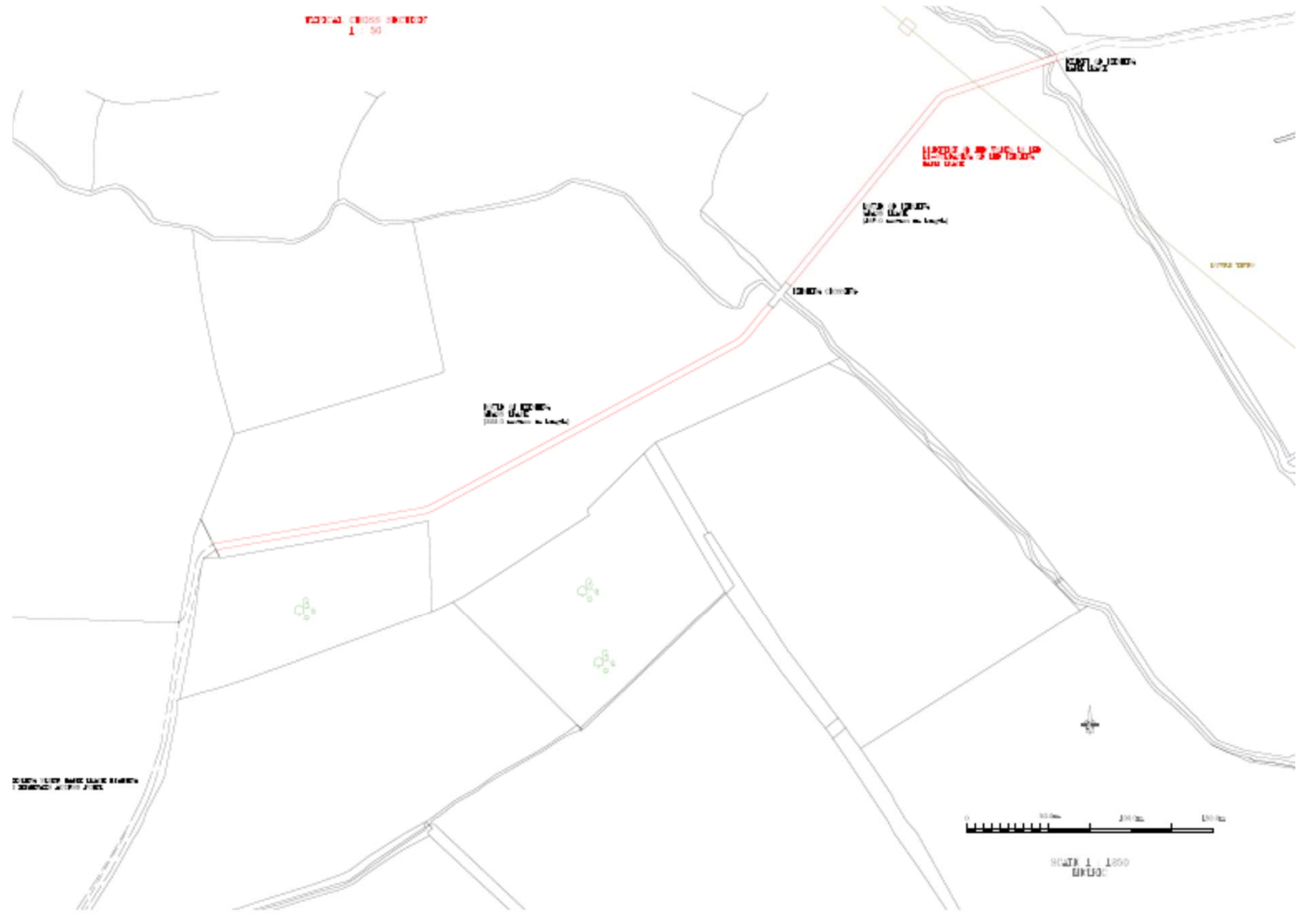

Typical cross section of access track, with site visit photos of the track that has been laid:

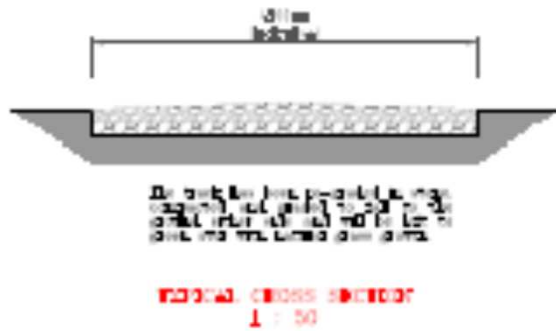





Eastern Area Planning Committee

3rd December 2020